

### DEKA SERIES

Date: 03/2019

Variant	Item No.	Description
19458	DEKA-BODY-WW	Recessed Inground/Wall Luminaire. Warm White 3000K
19459	DEKA-BODY-W	Recessed Inground/Wall Luminaire. White 5000K

Thank you for purchasing your new LED DEKA, Please take the time to read and understand the instruction sheet below. Failure to do so may void warranty.

### Specifications

Voltage:	12V DC	Lumen (±5%):	Warm White 3000K - 300lm White 5000K - 350lm	Dimmable:	No
Power:	3W	Beam Angle:	45° (Square, Round, Eyelid)	Lifespan:	50,000hrs
IP Rating:	65	CCT:	3000K - 5000K	CRI:	≥83

### Method of connection/s:

- Soldering or wire crimping is the preferred method of connection.
- Don't use block connectors/ wire nut connectors or any other connectors.
- Use approved heat shrink sealer for the inner sections where the two inner wires emerge and also the total outer section.
- Don't leave wires unsealed.
- Don't use PVC insulation tape as a sealer as this does not work.
- Don't use silicon as a method of sealing.
- Please use the correct cable gauge for all LED garden light fittings.
- It is recommended to use 0.75mm, 2 core rubberised flex or 1.5mm, 2 core rubberised flex.
- It is recommended to use 1000V rated cable.
- Don't use TPS (thermal plastic sheathing) twin or twin and earth.
- Don't use FIG8 low voltage garden cable.
- For any further information regarding installation/s please contact your local dealer.
- Ensure that adequate drainage has been used under each fitting, at least 100mm of blue metal or any other drainage type material must be used. Fittings must not sit in a pool of water as this will cause failure.

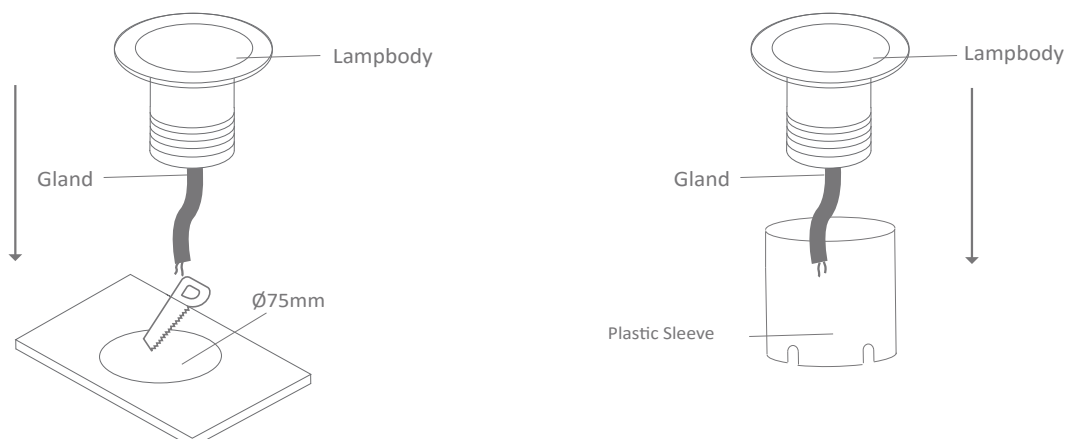

**Note:** -The lamp must be installed by professional electrician  
-Ensure the power supply is switched off before fitting this product

-Do not touch the lamp when in use  
-Keep away from hot steam and corrosive gas